



Property Features:

- + 78 Parking Spaces
- + Convenient Location East of I-35
- + High-Income Area
- + Quickly Growing Suburb

Gross Leaseable Area (GLA):

15,524 SF

Neighboring Businesses:

Holiday Gas Station, Lakeview Bank, Hosanna Church

Demographics:

	2016	1 Mile	3 Miles	5 Miles
Population		8,060	70,274	169,851
Households		2,617	26,347	63,097
Avg Household Income		\$142,689	\$101,501	\$99,184
City of Lakeville 2017				
Estimated Population - 63,748				
(13.8% increase from 2010)				



Tenant/Space Details

100 - Euro Nails	1,717 SF
101 - Pet Attitudes	1,098 SF
102 - Board & Batten	1,469 SF
102B - Board & Batten	1,201 SF
103 - Lakeville Family Health Clinic	3,456 SF
104 - Farmers Insurance	1,104 SF
105 - Healthy For Life Meals	979 SF
106 - AVAILABLE	1,145 SF
107 - Parlour 9 Salon & Spa	3,355 SF

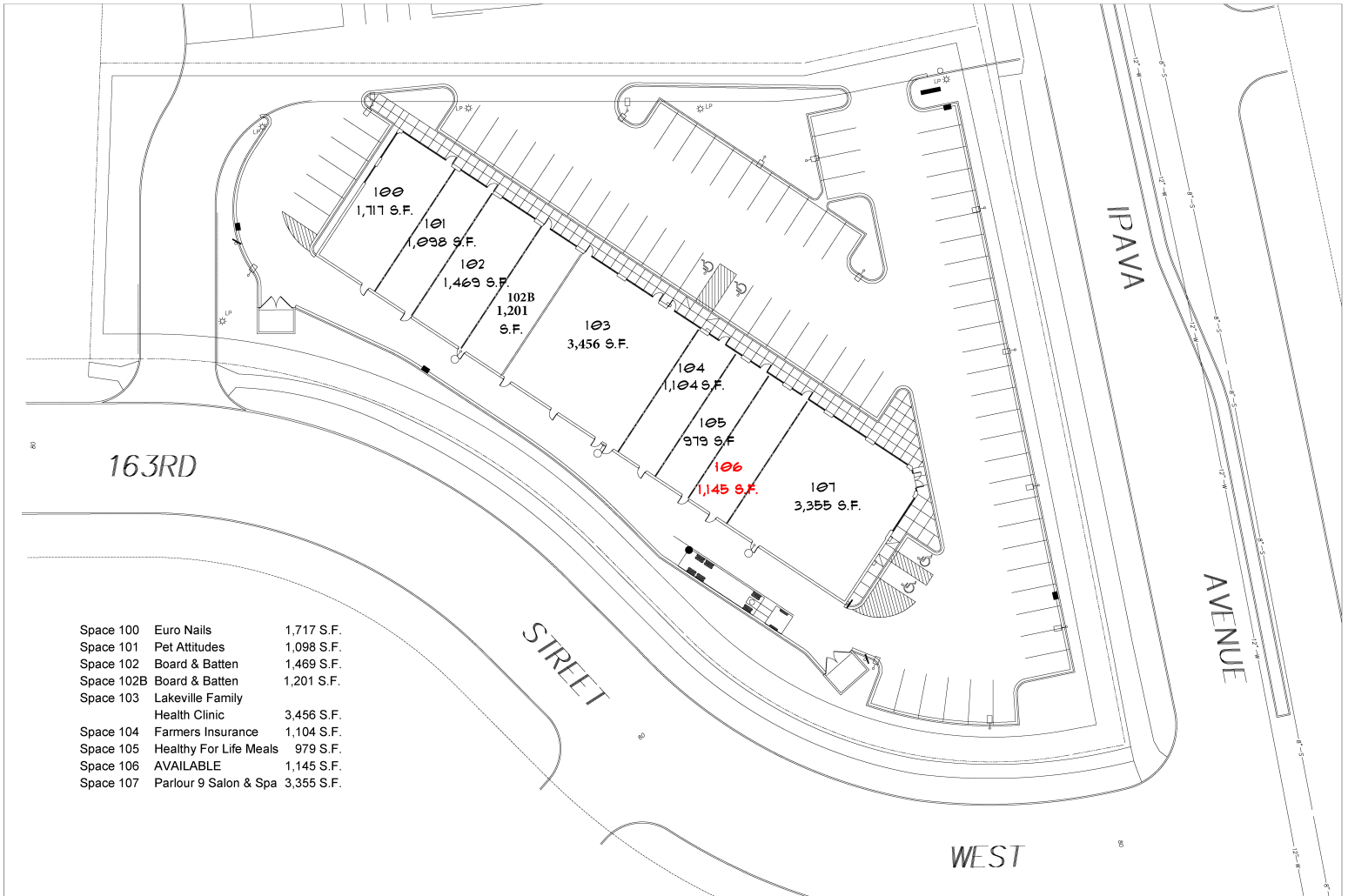

Space 100	Euro Nails	1,717 S.F.
Space 101	Pet Attitudes	1,098 S.F.
Space 102	Board & Batten	1,469 S.F.
Space 102B	Board & Batten	1,201 S.F.
Space 103	Lakeville Family Health Clinic	3,456 S.F.
Space 104	Farmers Insurance	1,104 S.F.
Space 105	Healthy For Life Meals	979 S.F.
Space 106	AVAILABLE	1,145 S.F.
Space 107	Parlour 9 Salon & Spa	3,355 S.F.